



DEMOCRATIC PARTY OF WISCONSIN
2014 STATE CONVENTION
JUNE 6 & 7 • WISCONSIN DELLS

CONVENTION PROGRAM

A NEW DIRECTION
FOR WISCONSIN



— Please Join —

Progressives United

FOR A
LIGHT BREAKFAST
AND COFFEE.

WHEN:
SATURDAY MORNING

TIME:
7:30 - 9:00 AM

Authorized and Paid for by Progressives United Political Action Committee, Christopher Louderback, Middleton, WI, Treasurer



WELCOME TO THE DEMOCRATIC PARTY OF WISCONSIN'S 2014 STATE CONVENTION

As we mark another year, and take a step forward towards the future, it is with optimism and excitement for a new direction for our Party, our movement, and our state with Mary Burke.

Now is the time to fight for progressive ideas harder than ever before, because that is how we will grow this economy and get Wisconsin back on track. It's time to take back our state from Tea Party extremists who want to sell Wisconsin out to the highest bidder.



So as we gather, we must commit not just as a political party, but as the electoral voice for the progressive movement, that we will do the work necessary to never again let us get into a position where we are fighting for our very right to survive. That we will stay true to Wisconsin's great progressive traditions of inclusion, fairness and acting as a voice for the powerless. That we will ensure every kid gets a great public education and everyone who works hard and plays by the rules has a chance to live the American Dream.

To do that we must unite to support and elect Mary Burke for Governor and John Lehman for Lieutenant Governor, because strong, progressive leadership is crucial to the future of our state.

With that in mind, to help start this election year with a bang, make sure to take away as much as you can from this year's convention. Make some new friends, form connections, and keep in mind the purpose of why we've gathered together; for our future, for our state, for our Wisconsin.

Thank you and enjoy the convention.

Mike Tate
Chair, Democratic Party of Wisconsin



DEMOCRATIC PARTY OF WISCONSIN
2014 STATE CONVENTION
JUNE 6 & 7 • WISCONSIN DELLS

CONVENTION AGENDA

Friday, June 6

- 2:00 PM Democratic Unity Fair Begins
(Sandstone Corridor)
- 3:00 PM Registration Opens (Tundra A, B, &C)
Black Caucus Meeting (Tundra D)
Latino Caucus Meeting (Tundra E)
LGBT Caucus Meeting (Tundra F)
- 3:30 PM American Indian Caucus Meeting (Glacier A)
Veterans Caucus Meeting (Glacier B)
- 4:00 PM County Chairs' Association Meeting
(Wilderness Ballroom Section 2)
Platform & Resolutions Committee Meeting
(Lake Delton Boardroom)
Welcome Hospitality Suite with
Congressman Kind
(Wilderness Ballroom Section 4)
- 4:30 PM New Delegate Orientation
(Wilderness Ballroom Section 1)
Labor Caucus Meeting (Tundra D)
Rural Caucus Meeting (Tundra E)
Women's Caucus Meeting (Tundra F)
- 5:00 PM Convention Hall Doors Open
(Sandstone Ballroom)

Friday, June 7 Continued

- 6:00 PM General Session Begins with the Call to Order, Presentation of Colors, Pledge of Allegiance, Invocation, and National Anthem
- 6:10 PM Speeches & Reports by Democratic Party Officers, Local Elected Officials, State Legislative Leaders, Congressional Delegation, Statewide Leaders and Special Guest Speakers
- 8:00 PM Registration Closes (Tundra A, B, &C)
- 9:00 PM General Session Ends and Hospitality Suites Begin (approx.)
- 12:00 AM Hospitality Suites End (approx.)

Saturday, June 7

- 8:00 AM Registration Opens (Tundra A, B, &C)
Convention Hall Doors Open
(Sandstone Ballroom)
- 8:30 AM Convention Reconvenes with
Platform & Resolutions Debate
- 10:00 AM Convention Reports
- 10:15 AM Speeches by Congressional and
Statewide Candidates
- 11:00 AM Registration Closes (Tundra A, B, &C)
Elevating Alternates to Delegates
(Tundra A, B, &C)
- 12:00 PM Raffle Winners Announced
(Sandstone Ballroom)
- 1:00 PM Convention Ends (Approx.)

NOW, MORE THAN EVER, WISCONSIN NEEDS A LEADER LIKE MARY BURKE.



A fourth-generation Wisconsinite, Mary Burke is Wisconsin through and through. Her commitment to the people of the state is endless and she'll work every day to better the lives of her fellow residents in the Badger state.

Her approach to business and politics is rooted in values of humility and hard work. Her father started their family bike manufacturing business in a barn in Waterloo. Trek, the once small-time bicycle start-up, is now a global leader in the industry and employs nearly 1,000 people in great, family-sustaining jobs right here in Wisconsin.

Mary grew up wanting to be a businessperson just like her father. His entrepreneurial spirit is in her blood, and it helped propel her to earn degrees from Georgetown University and Harvard Business School.



As a businesswoman, Mary is no stranger to success. She headed up Trek's European expansion, and in just three years expanded her division's sales from \$3 million to \$50 million. About ten years ago, Mary made the decision to resign from Trek in order to dedicate her time and her talents to bettering the community and was unanimously elected President of the Boys & Girls Club of Dane County. Through Mary's leadership and advocacy, the organization has increased the number of children it serves from 300 to 3,000 and watched its operating budget grow from \$250,000 to \$3.5 million.



Her results led to her being named Commerce secretary under Governor Jim Doyle. As secretary Mary took a solutions-oriented approach, seeking out all of the possible options and working with anyone – Democrat or Republican – who could help create more jobs and opportunity for all Wisconsinites. During her tenure Wisconsin's unemployment rate never topped 4.8%, and Wisconsin had 72,000 more jobs than it does today.

Outside of business and politics, Mary is committed to Wisconsin and her community. She believes in sharing the fruits of her success and it isn't out of the ordinary for her to quietly donate her own money to support non-profits and charity programs. But make no mistake, Mary's support doesn't stop with financial resources – she is an active and engaged participant in the execution of programs that benefit our communities. Mary founded AVID/TOPS, a student achievement partnership with the Madison school district designed to close the achievement gap. In just four years, students enrolled in the program have shown academic progress, graduation rates are up, and more low-income students and students of color are going to college.



The way we move forward as a state is with a progressive agenda that ensures every Wisconsinite who works hard and plays by the rules has the opportunity to climb the ladder of success.

For many, the opportunity to move up and get ahead has never presented itself. Mary Burke understands that the way we move forward as a state is with a progressive agenda that ensures every Wisconsinite who works hard and plays by the rules has the opportunity to climb the ladder of success. That's why after four years of division that has caused our state and our people such harm, Mary is a breath of fresh air for Wisconsinites who don't feel like they have a leader who is fighting for them.

THE FUTURE OF OUR PARTY AND OUR STATE HINGES ON ELECTING MARY BURKE IN NOVEMBER.

VISIT THE DEMOCRATIC UNITY FAIR

Exhibitors from various progressive organizations are assembled outside of the ballroom. Participants in this year's Democratic Unity Fair include:

- Chris Rockwood for Congress
- College Democrats of Wisconsin
- DPW Raffle Table
- DPW Women's Caucus
- Fair Wisconsin
- Ishmael Ozanne for Attorney General
- John Lehman for Lieutenant Governor
- Jon Richards for Attorney General
- Mary Burke for Wisconsin
- Northern Sun
- One Wisconsin Now
- Planned Parenthood of Wisconsin
- Progressive Democrats of America
- Progressives United
- Raise Wisconsin
- Ready for Hillary
- Rob Zerban for Congress
- State Representative Evan Goyke
- Susan Happ for Attorney General
- Tony Doom Supply Company
- Wisconsin Dells Visitor's Bureau
- Wisconsin Grassroots Network
- WisPolitics

And More!

RAFFLE

**BUY YOUR TICKETS FOR A CHANCE TO
WIN ONE OF OUR GREAT PRIZES!**

 **Milwaukee Brewers Baseball
Tickets**

*Courtesy of Jeff Christensen,
DPW 2nd Vice Chair*

 **Mary Burke Basket**
Courtesy of Burke for Wisconsin

 **Assorted County Party
Prize Baskets**

Courtesy of local county parties

 **Senator Tammy Baldwin Basket**
Courtesy of Tammy Baldwin for Senate

And more!

PROCEEDS WILL HELP DEMOCRATS WIN THIS NOVEMBER!

Tickets at 2 for \$5, 5 for \$10

- Raffle winners will be drawn at approximately 2:00PM on Saturday afternoon
- The winning ticket must be presented in person on Saturday afternoon following the raffle drawing to redeem a prize
- All proceeds go to the Democratic Party of Wisconsin



assembly
DEMOCRATS

*Join the Senate Democrats
and the Assembly Democrats*

*for drinks, dancing, and fun
at **9:00 PM** in our hospitality suite*

Complimentary beer and cash bar available!

2014 STATE DEMOCRATIC CONVENTION



***WELCOME
to the
Democratic
Convention in
Wisconsin Dells***

Greetings to Delegates and Guests,

I proudly represent the 4th Congressional District of Milwaukee County which includes Bayside, Brown Deer, Cudahy, Fox Point, Glendale, Milwaukee, Saint Francis, South Milwaukee, Shorewood, West Milwaukee and Whitefish Bay.

I am pleased we are meeting in Wisconsin Dells for the 2014 State Democratic Convention on June 6 and 7. We must continue the fight for progressive values

Congresswoman Gwen Moore

www.gwenmooreforcongress.com

PAID FOR BY MOORE FOR CONGRESS, ELLEN BRAVO, TREASURER

I STAND WITH PLANNED PARENTHOOD



facebook.com/ppawi



[@ppawi](https://twitter.com/ppawi)



shareyourstorywi.com

Volunteer:

ppawi.org/volunteer

Donate:

ppawi.org/donate

Sign Up for Email Updates:

ppawi.org/PPAN

Fellow Democrats: Thanks for all you do to make Wisconsin stronger.

Together, we'll replace Paul Ryan and turn this country around.

 www.RobZerban.com

 facebook.com/RobZerban

ROB ZERBAN
for Congress



Paid for by Rob Zerban for Congress

Getting You What You Need!

Tony Doom
Supply Company

We have been in the campaign & promotion supply business for over 30 years.

buttons • lapel stickers • bumper stickers • yard signs
magnetic car signs • balloons & MORE!

Call 800-658-2421 or 507-532-2407
or visit us at

www.TonyDoom.com

CONVENTION CENTER MAP

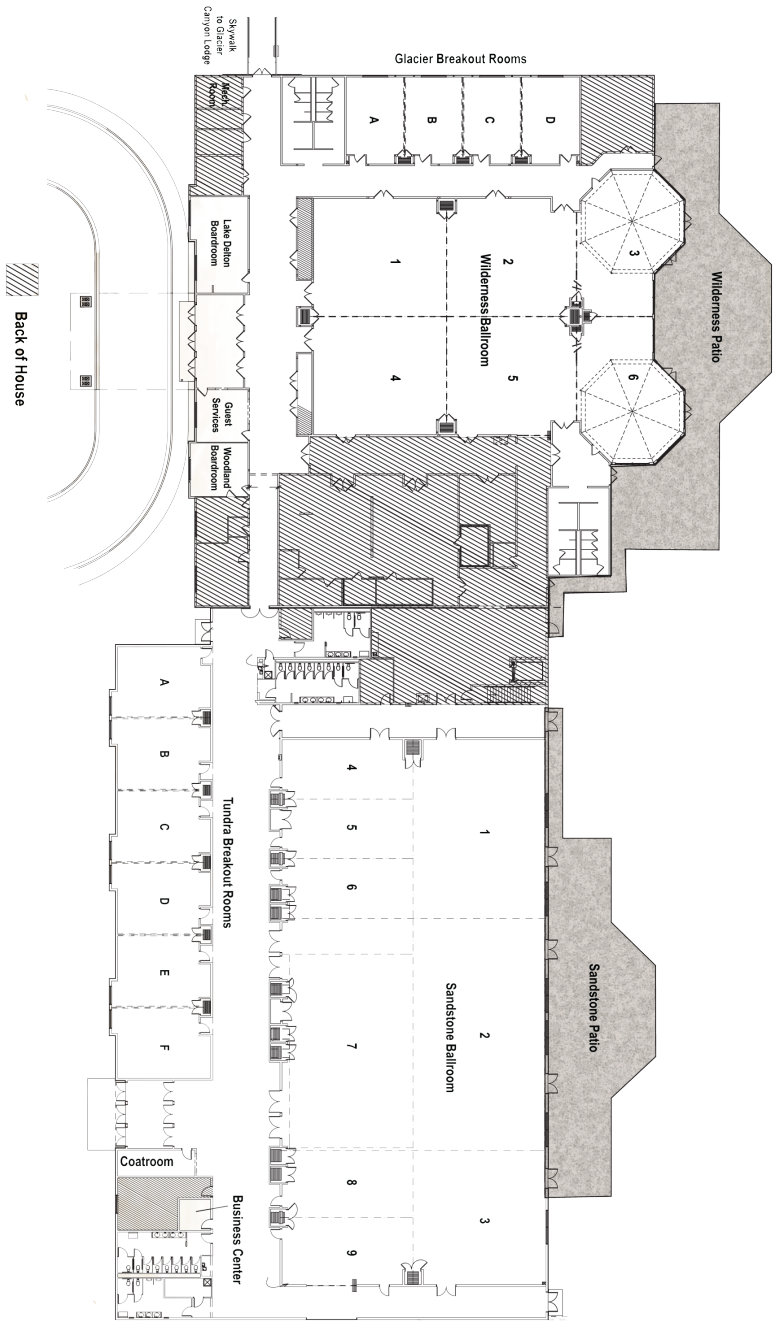



**EXPERIENCED PROSECUTOR
PROVEN LEADER**

**STANDING UP FOR THE PEOPLE OF WISCONSIN TO
PROTECT OUR RIGHTS, OUR SAFETY, AND OUR
ENVIRONMENT**

VOTE FOR ISMAEL OZANNE ON AUGUST 12TH!



Welcome Wisconsin Democrats!

Join
MARY BURKE
and
SENATOR TAMMY BALDWIN



for **BEER AND BRATS**
in their hospitality suite!

www.burkeforwisconsin.com

www.tammybaldwin.com

Paid for by Burke for Wisconsin, Sheila Conroy, Treasurer.